

How to Use The Snap Source® Products: The SnapSetter® Tool Adapters

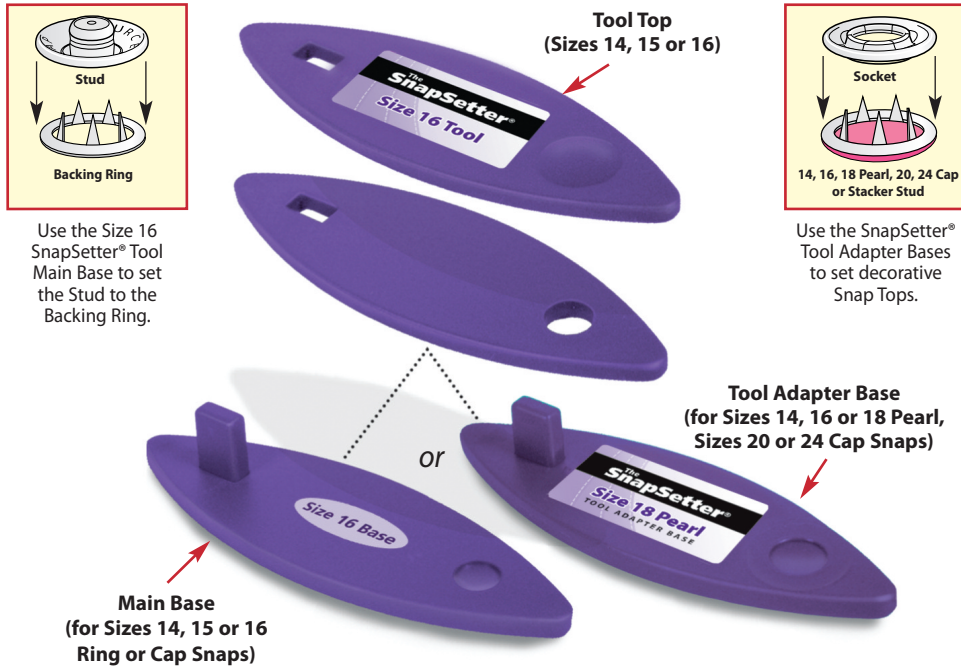

Value and versatility in one. It's a snap to use!

Simply interchange the appropriately sized SnapSetter® Tool Adapter Base with our Size 16 SnapSetter® Main Base to create a whole new "tool" with endless attaching possibilities.



Note: Be sure the appropriately sized 14, 16 and 18 Pearl or 20 and 24 Cap fits snugly into the indented area on the coordinating size Adapter Base. If the snap does not fit, the wrong size Tool Main or Adapter Base is being used.

For best results: To ensure a quality finished project, use our industrial long-prong snap fasteners.

Visit your local store for The Snap Source® products:

Caution: All packages contain small parts and should be kept out of reach of children.
All products are CPSIA Compliant
© 2015 The Snap Source, Inc.



How to Use The Snap Source® Products: Snaps

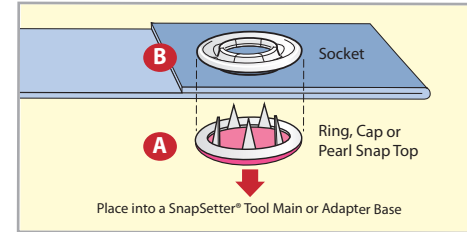

A Ring, Cap or Pearl Snap Top: This snap part is placed into the appropriate sized SnapSetter® Tool Main or Adapter Base with the prongs facing up. It is the decorative visible part on a project.

B Socket: This snap part is attached to the Ring, Cap or Pearl Snap Top (A) with the raised side of the Socket toward the prongs/fabric. Because this part looks similar on both sides, be sure the side with the slits on the inner ring resembling a flower faces up in the SnapSetter® Middle Positioning Bar.

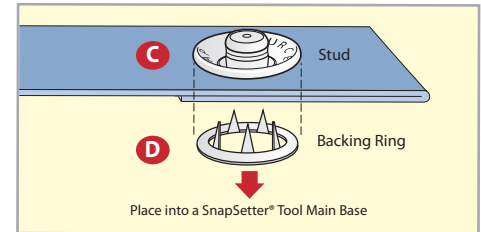

C Stud: This snap part attaches to the Backing Ring with the logo imprint facing up. The Stud "snaps" into the Socket when the attachment is complete.

D Backing Ring: This snap part is attached to the Stud (C) and completes the closure. It is placed into the appropriate size SnapSetter® Main Base with the prongs facing up.

For best results: To ensure a quality, precision fit, we recommend using our custom-designed SnapSetter® Attaching Tool and Adapters. Our Tools and Adapters protect snap components and line up the layers during attachment for a perfect snap setting experience.

Hints and Tips

Snaps are properly set when the:

- parts grip tightly into fabric and do not pull apart
- thumbnail cannot be forced between the snap parts and the fabric
- prongs are crimped tightly in the socket or stud

Interfacing: We recommend using an interfacing to help reinforce and protect the fabric surrounding the fasteners. For best results, use a sew-in material such as a woven/non-fusible interfacing, twill tape or similar weight cotton fabric.

Practice test: Always attach a practice snap set onto a fabric sample before sewing a project. Try opening and closing the sample to check for

stability or fabric stress. Adjust interfacing accordingly. If there is fabric stress, use a different snap fastener size or style.

To make an adjustable opening:

Attach a Snap Top and a Socket to the overlap, and two each of a Stud and Ring to the underlap. It is also acceptable to attach a Cap to a Stud, and use two each of a Socket and Ring to the underlap. Extra Snap Parts are available.

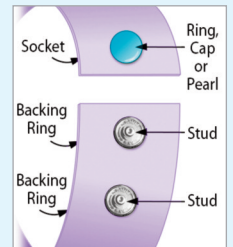

How to Use The Snap Source® Products

The SnapSetter® Snap Attaching Tool



The SnapSetter® has three parts:

Top (with label)

Middle Positioning Bar

Main Base

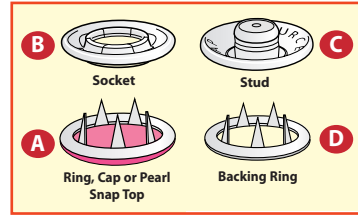
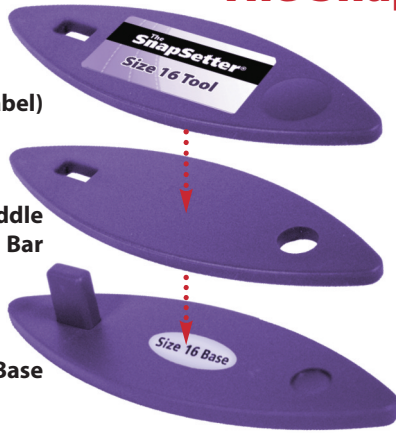

What's our secret to secure snap attachment? It's the SnapSetter®!

How does the SnapSetter® work?

Simply position the snap parts with fabric in-between the layers of the SnapSetter® and hammer into place.

Project Idea:

Replace the buttons on shirts with snaps. Simply attach the Snap Top/Socket over the existing buttonhole. Remove the button and attach the Stud/Ring in it's place.

Hints and Tips

To get into the tight areas surrounding multiple stitched layers on cuffs, diaper openings or jacket fronts:

Using any SnapSetter® Tool Main or Adapter Base, begin setting the snap. Hammer only once to set the snap loosely on the fabric. Disassemble the SnapSetter®. Reposition the fabric with snap onto the SnapSetter® Main or Adapter Base and place the Middle Positioning Bar over the post outward away from the Tool Base. Add the Tool Top. The only two SnapSetter® pieces touching the snap should be the Tool Top and Base allowing the fabric's bulky layers to not interfere with the attaching process. Hammer the Tool twice more to set the snap tightly onto the fabric.

The SnapSetter® Instructions:



1 Disassemble the three Tool pieces by pushing on the post while lifting the middle and top sections.

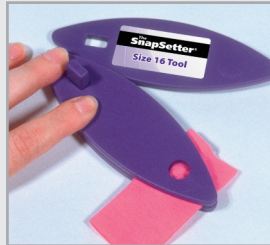

4 Slide the Middle Positioning Bar over the post onto the Main Base.



7 Hammer the snap parts into place on a firm surface, such as marble or steel.



2 Place the Tool Base on a firm surface. With prongs facing up, place the Snap Top (A) in the indented area of the Tool Base.



5 With the right side facing up, place the Socket (B) into the Middle Positioning Bar (the raised side down toward the fabric).*



8 Repeat steps 1-7 to attach the Backing Ring (D) to the Stud (C).



3 Place the fabric over the prong points.



6 Slide the Tool Top over the post onto the Middle Positioning Bar.

***Which way does the socket go?**
There is a right and a wrong side of the Socket. Place the Socket, with the raised side over prong points. Be sure the side with the slits on the inner ring faces up (looks like a flower). If the closure does not hold, the Socket was placed upside down.

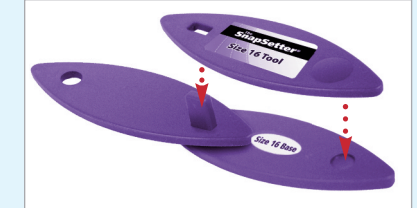

Removing Snaps:

If you need to remove a snap, gently twist a screwdriver back and forth to loosen the prongs all around the socket or stud. Repeat these steps to remove the parts from the opposite side of the garment.

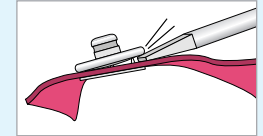

Double Closure:

Replace the Backing Ring with a Decorative Snap Top for a double closure of color.

